

LEGEND

- ⊗ EXISTING TREE TO REMAIN
- ⊗ EXISTING TREE TO BE REMOVED
- ⊙ EXISTING TREE TO REMAIN (NOT SHOWN ON SURVEY)
- ⊗ EXISTING TREE TO BE REMOVED (NOT SHOWN ON SURVEY)
- EXISTING STUMP TO BE REMOVED
- △ EXISTING TREE TO BE TRANSPLANTED
- ① TREE INDEX NUMBER

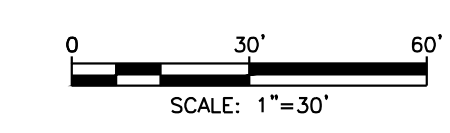
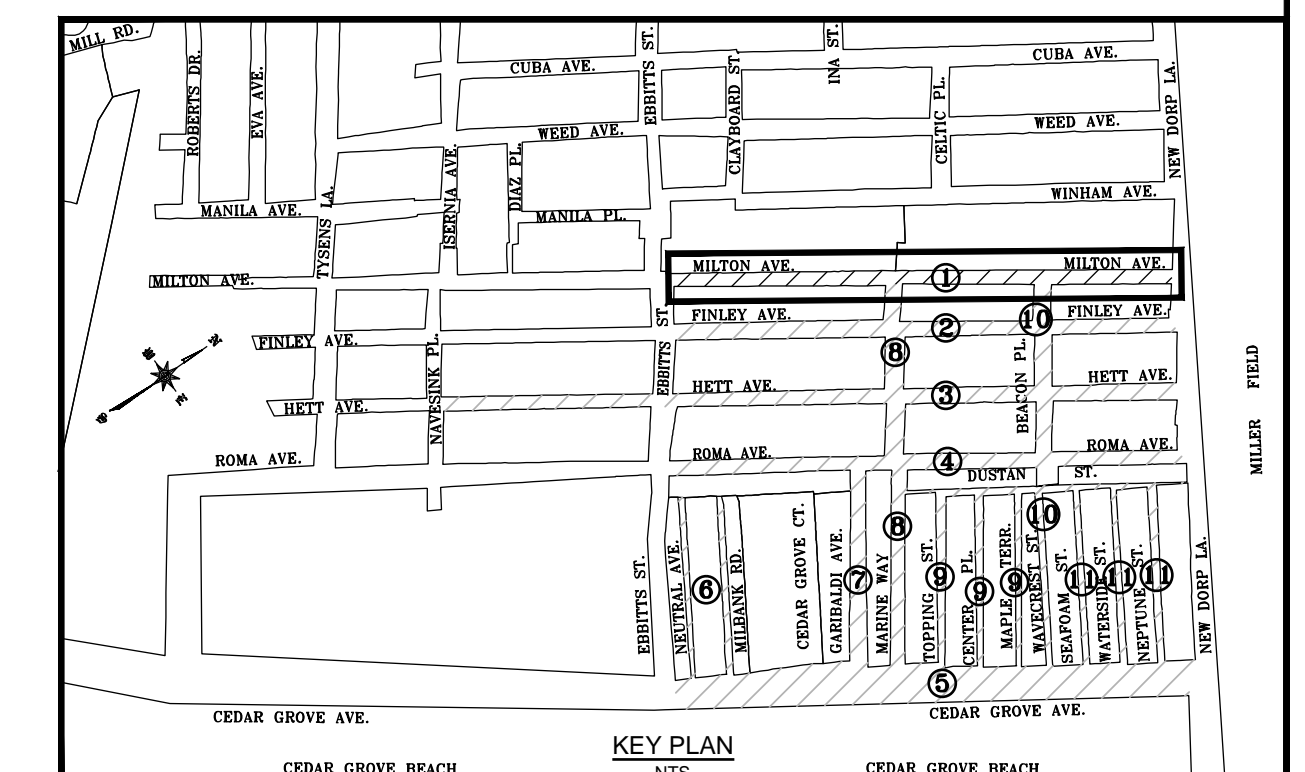
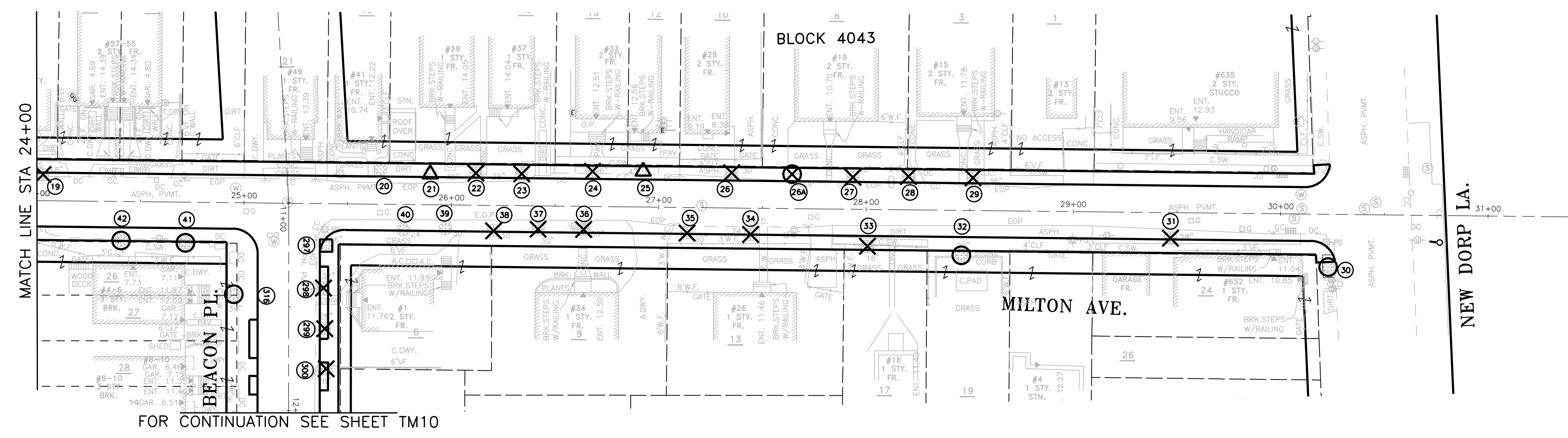

TOPOGRAPHIC SURVEY PREPARED BY:
 NAME OF SURVEYING FIRM
B. THAYER ASSOCIATES
 LICENSED LAND SURVEYOR

FINAL DESIGN PREPARED BY:
STV Incorporated
 SIGNATURE OF PRINCIPAL _____ DATE _____

DRAWN BY LU
 CADD FILE TM01.dwg

SCALE:
 AS SHOWN

CITY OF NEW YORK
 DEPARTMENT OF DESIGN AND CONSTRUCTION
 DIVISION OF INFRASTRUCTURE
 BUREAU OF DESIGN

MILTON AVENUE
 BETWEEN EBBITTS STREET TO NEW DORP LANE
 TREE IMPACT MITIGATION PLAN

NO.	DATE	DESCRIPTIONS REVISIONS	BY	APPR'D

ROMA AND HETT AVENUES
 BOROUGH OF STATEN ISLAND

CAPITAL PROJECT NO. **HWR669C** SHEET 112 OF 159

I:\Projects\10212277\0212277_0001\Drawings\ACTV\2014\TM01.dwg, d:\p\0212277_0001\Drawings\ACTV\2014\TM01.dwg, d:\p\0212277_0001\Drawings\ACTV\2014\TM01.dwg

TREE #	STATION POINT	CHANGE IN GRADE	STREET	SIDE	COMMON	DIAMETER BREST HEIGHT	CONDITION	HARDSCAPE DAMAGE	DAMAGE EXTENT (INCHES)	NOTES	MITIGATION #
1	11+72	0.49	Ebbitts St (On Milton Ave)	North	Zelkova	6	Good	No	0		STP
2	14+12	DEAD	Milton Ave	North	Zelkova	4	Dead	No	0		REMOVAL
3	14+91	1.55	Milton Ave	North	London Planetree	36	Good	No	0		REMOVAL
4	17+30	-0.01	Milton Ave	North	Sycamore Maple	20	Poor	No	0		REMOVAL
5	17+48	0.01	Milton Ave	North	Ash	8	Good	No	0	Trunk wounds	REMOVAL
6	18+11	-0.23	Milton Ave	North	London Planetree	24	Good	Yes	0	Sidewalk heaved/cracked	REMOVAL
7	18+29	-0.24	Milton Ave	North	London Planetree	26	Good	Yes	0	Sidewalk heaved/cracked	REMOVAL
8	20+31	0.41	Milton Ave	North	London Planetree	24	Good	Yes	0	Sidewalk heaved/cracked, roots girdling	REMOVAL
9	21+12	0.36	Milton Ave	North	London Planetree	36	Good	No	0		REMOVAL
10	21+49	0.23	Milton Ave	North	London Planetree	24	Good	No	0		REMOVAL
11	21+64	0.26	Milton Ave	North	London Planetree	24	Good	No	0		REMOVAL
11A	21+85	0.30	Milton Ave	North	London Planetree	24	Good	No	3	Hangers	*REMOVAL
12	22+10	0.52	Milton Ave	North	London Planetree	36	Good	No	3	Trunk decay, sidewalk heaved	REMOVAL
13	22+30	0.46	Milton Ave	North	London Planetree	28	Good	Yes	0	Sidewalk heaved	REMOVAL
14	22+70	0.35	Milton Ave	North	London Planetree	36	Good	No	0		REMOVAL
15	22+90	0.30	Milton Ave	North	London Planetree	24	Good	No	0		REMOVAL
16	23+10	0.23	Milton Ave	North	London Planetree	38	Good	No	3	Trunk wounds	REMOVAL
17	23+34	0.13	Milton Ave	North	London Planetree	38	Good	No	0	Wood planter	REMOVAL
18	23+87	-0.12	Milton Ave	North	Silver Maple	8/8	Good	Yes	1	Two stems, sidewalk heaved/cracked, roots girdling	REMOVAL
19	24+03	-0.19	Milton Ave	North	Silver Maple	17/23/11	Fair	Yes	0	Four stems, sidewalk heaved, roots girdling	REMOVAL
20	25+66	NF	Milton Ave	North			Not Found	No	0		
21	25+90	-0.66	Milton Ave	North	Oak	2	Fair	No	0	Newly planted	TRANSPLANT
22	26+12	DEAD	Milton Ave	North	DEAD	2	Dead	No	0	Newly planted	REMOVAL
23	26+34	-0.13	Milton Ave	North	London Planetree	23	Fair	No	0		REMOVAL
24	26+68	0.39	Milton Ave	North	Callery Pear	6	Good	No	3	Brick planter	REMOVAL
25	26+92	0.58	Milton Ave	North	Callery Pear	4	Good	No	3	Brick planter	TRANSPLANT
26	27+35	1.34	Milton Ave	North	London Planetree	30	Poor	Yes	0	Asphalt cracked	*REMOVAL
26A	27+64±	1.64	Milton Ave	North	London Planetree	26	Fair	Yes	1	Growing into sidewalk	REMOVAL
27	27+94	1.92	Milton Ave	North	London Planetree	25	Fair	No	0	Hangers, slime flux	REMOVAL
28	28+20	1.92	Milton Ave	North	London Planetree	24	Good	No	0		REMOVAL
29	28+51	2.30	Milton Ave	North	London Planetree	36	Fair	No	0		REMOVAL
30	30+23	0.00	New Dorp Ln	South	Cherry	3	Good	No	0		STP
31	29+37		New Dorp Ln (On Milton Ave)	South	London Planetree	28	Poor	Yes	0	Roots girdling, slim flux	*REMOVAL
32	28+46	2.19	Finley Ave (On Milton Ave)	South	Oak	22	Excellent	No	0	Behind fence - beyond property line	STP
33	28+01	DEAD	Milton Ave	South	DEAD	16	Dead	Yes	1	Sidewalk heaved/cracked, root damage, behind fence	REMOVAL
34	27+45	1.45	Milton Ave	South	London Planetree	24	Fair	No	0		*REMOVAL
35	27+14	1.17	Milton Ave	South	London Planetree	20	Good	No	0		REMOVAL
36	26+64	0.77	Milton Ave	South	London Planetree	30	Good	No	0		REMOVAL
37	26+42	0.61	Milton Ave	South	London Planetree	30	Fair	No	0	Growing into sidewalk	REMOVAL
38	26+21	0.46	Milton Ave	South	London Planetree	30	Poor	No	0	Trunk damage	REMOVAL
39	25+98	NF	Beacon PI (On Milton Ave)	South		30	Not Found	No	0		
40	25+77	NF	Beacon PI (On Milton Ave)	South		47	Not Found	No	0		
41	24+72		Beacon PI (On Milton Ave)	South	Callery Pear	9	Good	No	0	Brick planter	STP
42	24+41	-0.24	Beacon PI (On Milton Ave)	South	Callery Pear	9	Good	No	0	Brick planter	STP
43	23+00	0.46	Milton Ave	South	London Planetree	18	Fair	No	0	Girdling roots; root damage, leaning trunk	REMOVAL
44	22+72	0.73	Milton Ave	South	London Planetree	36	Poor	Yes	0	Growing into road, curb damage, leaning trunk	*REMOVAL
45	21+29	0.54	Milton Ave	South	London Planetree	30	Good	Yes	0	Growing into road, curb damage, unbalance crown	REMOVAL
46	21+05		Milton Ave	South	STUMP	24	Poor	No	0	Growing into road, unbalance crown	REMOVAL
46A	20+20		Milton Ave	South	Cherry	2	Excellent	No	0	Newly planted	REMOVAL
47	19+35	0.47	Milton Ave	South	London Planetree	28	Poor	No	0		REMOVAL

LEGEND: *REMOVAL = Tree marked by NYCDPR for removal - no restitution **REMOVAL = Removal without restitution STP = Standard Tree Protection MTP = MultiTree Protection

NO.	DATE	DESCRIPTIONS	BY	APPR'D

I:\Projects\10212277\0212277_0001.Dr-wings\CIV\2014\T101.dwg, d:\p\reec3 01/12/16 - 4:45pm

TOPOGRAPHIC SURVEY PREPARED BY: NAME OF SURVEYING FIRM B. THAYER ASSOCIATES LICENSED LAND SURVEYOR	FINAL DESIGN PREPARED BY: STV Incorporated SIGNATURE OF PRINCIPAL _____ DATE _____	DRAWN BY <u>AJC</u> CADD FILE <u>T101.dwg</u>	SCALE: AS SHOWN	CITY OF NEW YORK DEPARTMENT OF DESIGN AND CONSTRUCTION DIVISION OF INFRASTRUCTURE BUREAU OF DESIGN	TREE IMPACT MITIGATION TABLES	ROMA AND HETT AVENUES BOROUGH OF STATEN ISLAND CAPITAL PROJECT NO. HWR669C	SHEET 123 OF 159 T101 T108
--	---	--	--------------------	---	-------------------------------	---	----------------------------------